

# G Floor, 10 Ironmonger Lane

City of London

Sq Ft: 565

Monthly Price: £7,000





# Floor Plan

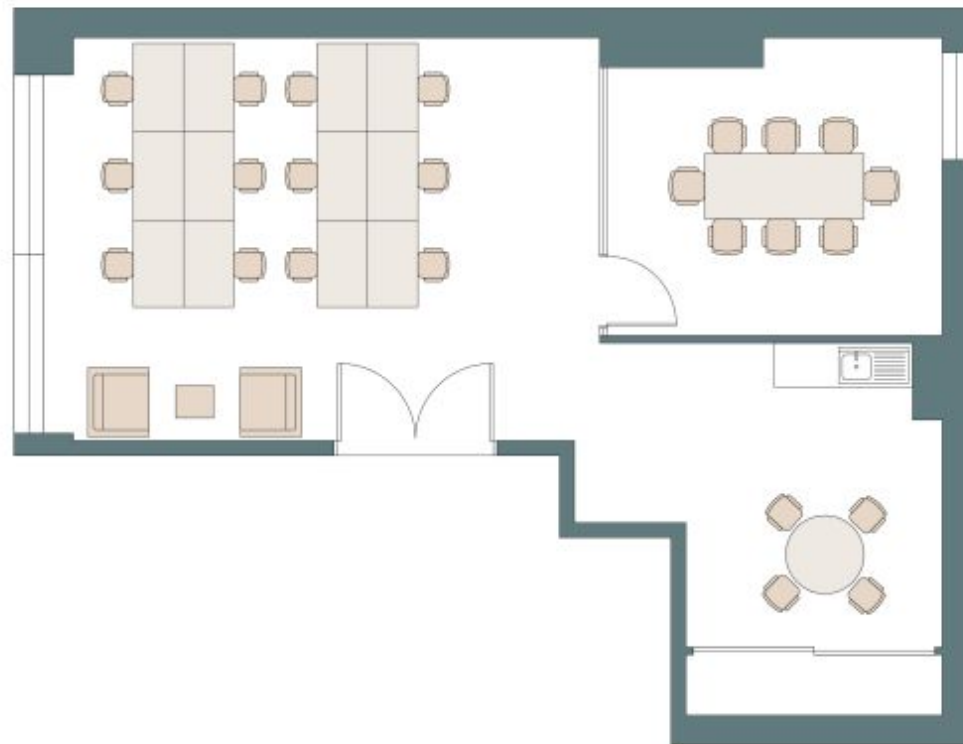

# About This Workspace

10 Ironmonger Lane offers a modern and efficient workspace in the heart of the City of London, perfect for smaller businesses looking to establish a central presence. The contemporary interiors are designed with functionality and style in mind, creating a welcoming environment that's well-suited for productivity. Situated in a prime location, 10 Ironmonger Lane provides easy access to the area's renowned financial and professional services, along with a variety of shops, cafés, and transport links. This office is ideal for businesses seeking a smart, well-connected base in London's bustling business district.

# Workspace Amenities



Air Conditioning



Excellent Natural Light



Meeting Rooms

# Workspace Specification

Floor/Unit	Status	Size	Price	Term
G Floor	Available	565	£7,000	24 months

# Connectivity

10 Ironmonger Lane offers a modern and efficient workspace in the heart of the City of London, perfect for smaller businesses looking to establish a central presence. The contemporary interiors are designed with functionality and style in mind, creat...



 Bank Station – 4 mins walk



 St Paul's – 7 mins walk



 Moorgate – 11 mins walk



# Workspace Services

Included in your sub800 workspace



## Remote Concierge Service

Our remote concierge team is on hand to support you. From sourcing catering for important meeting, to planning wellness workshops, and everything in between...



## Food & Beverage Deliveries

Enjoy a tailored choice of food and beverages delivered to your office. Our selections are carefully curated by our team to offer your business delightful options.



## Internet & Technology

Select from a variety of internet bandwidth options, along with access to other technology products to upgrade your space



## Cleaning & Waste Services

Access to allocated cleaning slots, reporting and products to suit your team's needs. Our cleaning saves you time arranging cleaning or doing it yourself.



## Furniture & Fit-Out

Browse on the sub800 shop for our extensive range of furniture items, meeting room installations, have a bespoke consultation with our team.



## Health & Safety Onboarding

A comprehensive health and safety onboarding pack that details how you can ensure your workspace is safe, as well as a list of preferred suppliers and rates



## Repairs & Support

sub800 provide your business with light repairs and the option to source specialist works with preferred suppliers and rates



## Member's Club Access

Access to exclusive member's clubs for the C-Suite level of your team, giving them access to external meeting space, events and networking opportunities

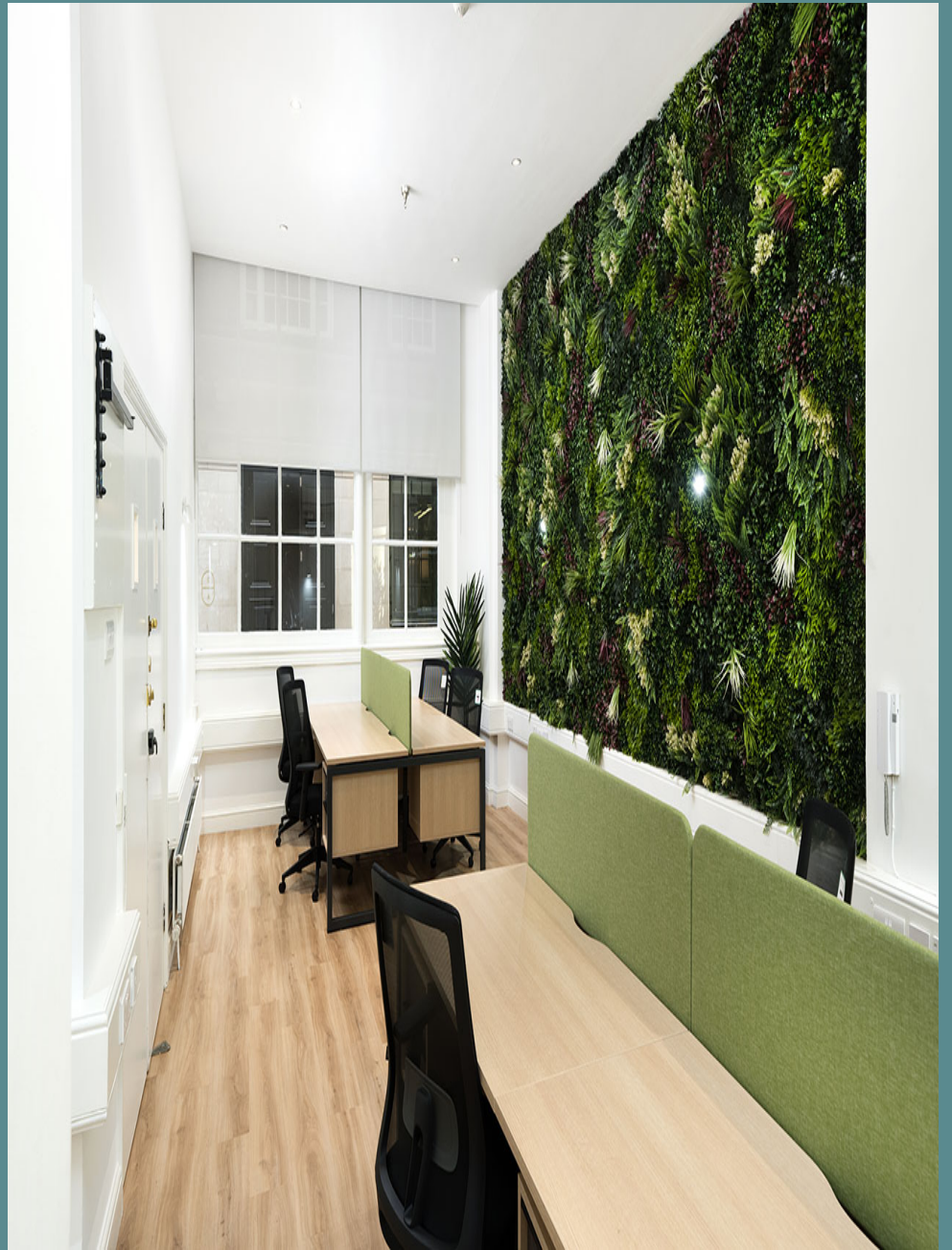



[Make An Enquiry](#)

[Book A Viewing](#)

[enquiries@sub800.com](mailto:enquiries@sub800.com) | [0207 052 3025](tel:02070523025) | [www.sub800.com](http://www.sub800.com)